

RTP System

Sta-Lok's RTP system is designed for application in glass façades, providing tension and support between hollow sections. High tensile threaded rod sits in the hollow members to connect the RTP end fittings to provide a sleek and minimalistic appearance. System lengths up to 6 metres are available, rod connectors can be used to achieve longer spans.

- Tension rods and RTP components are machined from solid stainless steel alloys offering maximum strength and superiority over other manufacturing processes
- Tie rods adjustment is achieved by rotating in a clockwise/counter clockwise direction
- Machined Spanner Flats included as standard
- Right hand threaded rod is supplied with each RTP system to connect the RTP ends through the hollow sections
- Conical locking nuts cover tie rod threads to provide a clean line between the rod and end fitting
- Tie rod systems are supplied ready to install. RTP ends are pre-assembled and adjusted to your end to end requirements
- Available in Satin (standard) or Polished Finish

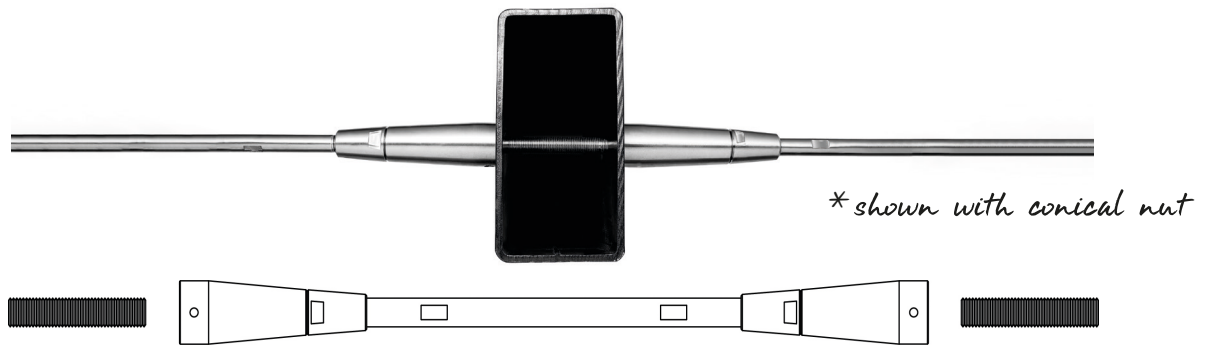

Reference	Thread		Assembly Adjustment +/-		Yield Loads		Break Loads	
	Metric	UNF	MM	Inch	KN	KIPS	KN	KIPS
RTP2S-M6	M6		15	0.591	8.9	2.00	12.5	2.81
RTP2S-14		1/4	15	0.591	7.5	1.69	14.3	3.21
RTP2S-M8	M8		15	0.591	16.4	3.69	23.0	5.17
RTP2S-516		5/16	15	0.591	12.1	2.72	22.9	5.15
RTP2S-M10	M10		15	0.591	26.1	5.87	36.6	8.23
RTP2S-38		3/8	15	0.591	18.6	4.18	35.3	7.94
RTP2S-M12	M12		15	0.591	38.1	8.57	53.4	12.00
RTP2S-12		1/2	15	0.591	34.1	7.67	64.8	14.57
RTP2S-M16	M16		15	0.591	72.1	16.21	100.9	22.68
RTP2S-58		5/8	15	0.591	54.9	12.34	104.3	23.45
RTP2S-M20	M20		20	0.787	103.6	23.29	144.0	32.37
RTP2S-34		3/4	20	0.787	80.4	18.07	137.8	30.98
RTP2S-M22	M22		20	0.787	129.5	29.11	180.1	40.49
RTP2S-78		7/8	20	0.787	109.9	24.71	188.4	42.35
RTP2S-M24	M24		20	0.787	149.2	33.54	207.5	46.65
RTP2S-100		1	20	0.787	142.9	32.13	245.0	55.08
RTP2S-M27	M27		20	0.787	196.4	44.15	273.3	61.44
RTP2S-118		1 1/8	20	0.787	243.7	54.79	339.3	76.28
RTP2S-M30	M30		25	0.984	238.7	53.66	332.1	74.66
RTP2S-114		1 1/4	25	0.984	307.1	69.04	427.3	96.06
RTP2S-M36	M36		25	0.984	349.2	78.50	485.8	109.21

RTP Dimensions

A fully machined RTP end with sleek geometry and a minimalistic look.

- Manufactured from high quality stainless steel
- Available with left and right hand Metric or UNF machined internal threads
- Available in Satin (standard) or Polished Finish
- Supplied with conical nut as standard. Alternative locking nut options are available (page 33)

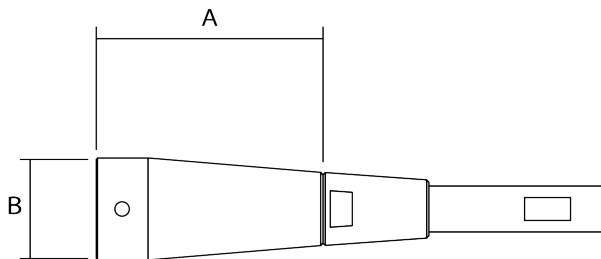

** shown with conical nut*

Reference		Thread		A		B	
Left Hand	Right Hand	Metric	UNF	MM	Inch	MM	Inch
RTP-M6L	RTP-M6R	M6		45.0	1.772	14.0	0.551
RTP-14L	RTP-14R		1/4	45.0	1.772	14.0	0.551
RTP-M8L	RTP-M8R	M8		51.0	2.008	17.0	0.669
RTP-516L	RTP-516R		5/16	51.0	2.008	17.0	0.669
RTP-M10L	RTP-M10R	M10		61.0	2.402	25.0	0.984
RTP-38L	RTP-38R		3/8	61.0	2.402	25.0	0.984
RTP-M12L	RTP-M12R	M12		63.0	2.480	32.0	1.260
RTP-12L	RTP-12R		1/2	63.0	2.480	32.0	1.260
RTP-M16L	RTP-M16R	M16		75.0	2.953	38.0	1.496
RTP-58L	RTP-58R		5/8	75.0	2.953	38.0	1.496
RTP-20L	RTP-M20R	M20		89.0	3.504	44.0	1.732
RTP-34L	RTP-34R		3/4	89.0	3.504	44.0	1.732
RTP-M22L	RTP-M22R	M22		105.0	4.134	50.0	1.969
RTP-78L	RTP-78R		7/8	105.0	4.134	50.0	1.969
RTP-M24L	RTP-M24R	M24		119.0	4.685	57.0	2.244
RTP-100L	RTP-100R		1	119.0	4.685	57.0	2.244
RTP-M27L	RTP-M27R	M27		130.0	5.118	63.0	2.480
RTP-118L	RTP-118R		1 1/8	130.0	5.118	63.0	2.480
RTP-M30L	RTP-M30R	M30		140.0	5.512	69.0	2.717
RTP-114L	RTP-114R		1 1/4	140.0	5.512	69.0	2.717
RTP-M36L	RTP-M36R	M36		161.0	6.339	82.0	3.228